

Description of Parts

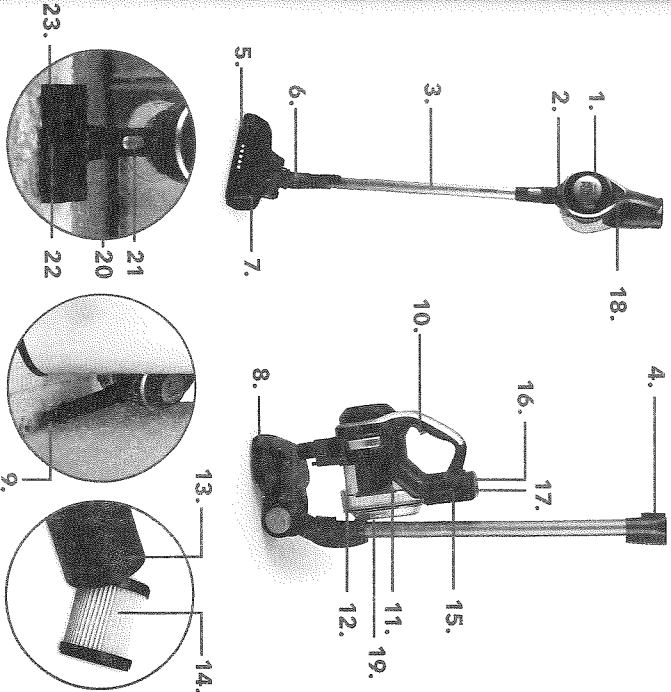

- | | |
|---------------------------------------|------------------------------------|
| 1. Airglity Pet Plus+ main unit | 13. Filter cone |
| 2. Air inlet | 14. HEPA filter |
| 3. Extension tube | 15. Battery pack |
| 4. Extension tube release button | 16. Battery release catch |
| 5. Floor brush | 17. Charging port |
| 6. Floor brush release button | 18. LED indicator light |
| 7. Brush bar | 19. Storage hook |
| 8. Brush bar release tab | 20. Pet tool |
| 9. 2 in 1 crevice and brush tool | 21. Pet tool release button |
| 10. Power trigger | 22. Pet tool brush bar |
| 11. Dust container | 23. Pet tool brush bar release tab |
| 12. Dust container base release latch | |

Before First Use

Before using the vacuum cleaner for the first time, clean the exterior surface with a soft, damp cloth and dry thoroughly.

Charging the Airglity Pet Plus+

Before first use, the vacuum cleaner must be charged for approx. 5.5 hours. Subsequent charging times will vary dependent upon use.

The battery pack must be fitted onto the vacuum cleaner main unit during charging; do not charge the battery pack separately. **STEP 1:** Before connecting to the mains power supply, attach the battery pack to the main unit so it clicks.

STEP 2: Connect the mains power adaptor to the charging port on the battery pack.

STEP 3: Plug the mains power adaptor into the mains power supply; the LED indicator light will flash during charging and then remain illuminated once the battery is fully charged.

STEP 4: Unplug the mains power adaptor from the mains power supply once the battery is fully charged. Disconnect the mains power adaptor from the charging port on the battery pack.

Using the Airglity Pet Plus+

STEP 1: Check that the vacuum cleaner is disconnected from the mains power adaptor. Make sure that the battery pack is securely attached to the main unit.

STEP 2: Turn on the vacuum cleaner by pressing the power trigger; press once for the minimum power setting, press twice to use the maximum power setting.

STEP 3: To turn off the vacuum cleaner, press the power trigger.

Using the Pet Tool

STEP 1: Push the pet tool onto the end of the extension tube or the suction hose neck if the extension tube is not being used.

STEP 2: Turn on the vacuum cleaner by pulling the power trigger; press the power trigger again to activate high speed. Pull the power trigger again to switch the vacuum cleaner off.

Warning: Do not use the pet tool on pets.

Cleaning the HEPA Filter

The dust container and filter need to be emptied and cleaned regularly to preserve suction and prolong the life of the vacuum cleaner.

Storage

Check that the vacuum cleaner is cool, clean and dry before storing in a cool, dry place.

The vacuum cleaner can be neatly stored away after use by securing the main unit onto the extension tube using the storage hook.

Specifications

Product code: BEL01195-150
 Battery: 22.2 V 2200 mAh Li-ion
 Adaptor input: 100-240 V ~ 50/60 Hz
 Adaptor output: 26 V  0.4 A 10.4 W
 Average active efficiency: 83.81 %
 Efficiency at low load (10 %): 75.78 %
 No load power consumption: 0.01 W
 Dust tank capacity: 1.2 L

If this product does not reach you in an acceptable condition please contact our Customer Services Department at www.beldray.com. Please have your delivery note to hand as details from it will be required. If you wish to return this product, please return it to the retailer from where it was purchased with your receipt (subject to their terms and conditions).
 Go to <http://www.beldray.com/manuals.html> and search **BEL01195-150** to access the instruction manual for your product.

*To be eligible for the extended guarantee, go to https://guarantee.upgs.com/beldray/ and register your product within 30 days of purchase.

Rechargeable batteries are not included in the extended manufacturer's guarantee (after the first 12 months).



FULL INSTRUCTION MANUAL AT
<https://www.beldray.com/manuals.html>
 PRODUCT CODE: BEL01195-150

Beldray ^{est 1872}
 FOR 150 YEARS

AIRGLITY
PET PLUS+
 QUICK START GUIDE

Find us on 

www.facebook.com/Beldray

Manufactured by:
 UP Global Sourcing UK Ltd.,
 UK, Manchester OL9 0DD.
 Germany, 51149 Köln.
 MADE IN CHINA.
www.beldray.com

Safety Instructions

When using electrical appliances, basic safety precautions should always be followed.

Check that the voltage indicated on the rating plate corresponds with that of the local network before connecting the appliance to the mains power supply. Children aged from 8 years and people with reduced physical, sensory or mental capabilities or lack of experience and knowledge can use this appliance only if they have been given supervision or instruction concerning use of the appliance in a safe way and understand the hazards involved.

Children should be supervised to ensure that they do not play with the appliance. Unless they are older than 8 and supervised, children should not perform cleaning or user maintenance.

This appliance contains no user serviceable parts. If the power supply cord, plug or any part of the appliance is malfunctioning or if it has been dropped or damaged, do not use. Only a qualified electrician should carry out repairs. Improper repairs may place the user at risk of harm.

Do not remove the adaptor from the mains power supply by pulling the cord; switch off and remove the plug by hand.

Do not use the adaptor to recharge non-rechargeable batteries or any other appliance.

Do not use the appliance for anything other than its intended use.

Take care when equipping accessories with rotating parts as this could cause entrapment.

Switch off the appliance, disconnect it from the mains power supply and allow to cool fully before changing or fitting accessories

and before cleaning or user maintenance. Use of an extension cord with the appliance is not recommended.

Only use the appliance with the power supply unit provided.

This appliance should not be operated by means of an external timer or separate remote control system.

This appliance is intended for domestic use only. It should not be used for commercial purposes.

Caution: The extension tube contains electrical connections. Do not use to suck up water. Do not immerse in water for cleaning. The extension tube should be checked regularly and must not be used if damaged.

Battery Safety

The supply terminals are not to be short-circuited.

In the event of a battery pack leaking, do not allow the liquid to come in contact with the skin or eyes. If contact has been made, wash the affected area with copious amounts of water and seek medical advice.

Secondary cells and batteries need to be charged before use. After extended periods of storage, it may be necessary to charge and discharge the battery pack several times to obtain maximum performance.

Do not leave a battery pack on prolonged charge when not in use.

Do not use any charger other than that specifically provided for use with the product.

Do not use any cell or battery which is not designed for use with the product.

Keep batteries out of the reach of children.

Do not crush, puncture, dismantle or otherwise damage the battery pack.

Do not store above 60 °C.

Avoid storage in direct sunlight.

Do not expose the battery pack to heat or fire as it may explode.

Do not subject the battery pack to mechanical shock.

To dispose of the exhausted battery pack, take it to a local recycling station.

Contact the local government offices for further details.

This appliance is fitted with a 22.2 V 2200 mAh Li-ion rechargeable battery (non-removable).

Dos and Dont's

Do:

Charge the unit fully before first use.

Check that the HEPA filter is kept clear of obstruction.

Make sure that the dust container and HEPA filter are cleaned regularly.

Don't:

Use the vacuum cleaner without the HEPA filter or dust container in position.

Use the vacuum cleaner to pick up flammable liquid, matches, cigarette ends, hot ashes or any hot, burning or smoking objects.

Use the vacuum cleaner to pick up water or any other liquid, as this poses risk of an electric shock.

Care and Maintenance

Wipe the external surface of the vacuum cleaner with a soft, damp cloth and allow to dry thoroughly.

Do not use any harsh or abrasive detergents or cleaning agents.

Do not immerse the vacuum cleaner in water or any other liquid.

WARNING - MUST READ

THE PET TOOL MAY BECOME CLOGGED WITH PET HAIR AND OTHER DEBRIS. TO MAINTAIN OPTIMUM PERFORMANCE, CLEAN IT FREQUENTLY:

- 1. REMOVE THE PET TOOL FROM THE EXTENSION TUBE OR SUCTION HOSE.**
- 2. PUSH THE PET TOOL BRUSH BAR RELEASE TAB AND ROTATE THE PET TOOL BRUSH BAR IN AN ANTICLOCKWISE DIRECTION.**

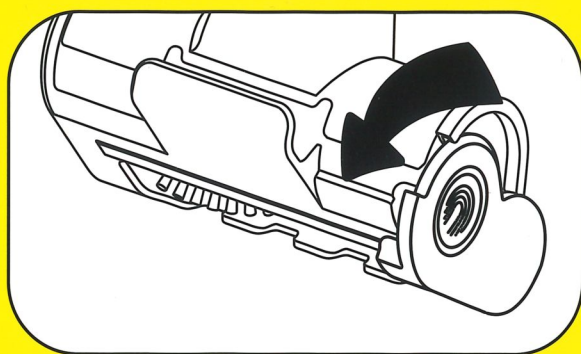

- 3. LIFT THE BRUSH BAR AND IMPELLER OUT OF THE PET TOOL. REMOVE ANY DEBRIS FROM THE BRUSH BAR.**
- 4. ONCE CLEANED, REPLACE THE BRUSH BAR. THE SPINDLE END OF THE IMPELLER SHOULD BE ALIGNED WITH THE SLOT ON THE BRUSH BAR WITH THE TOOL IN AN UPRIGHT POSITION.**
- 5. TWIST THE BRUSH BAR IN A CLOCKWISE DIRECTION UNTIL IT LOCKS INTO PLACE.**

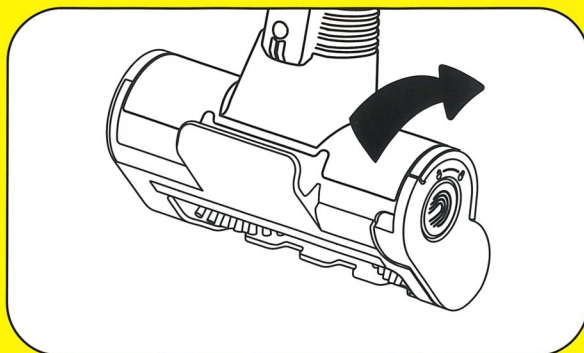

TAKE CARE WHEN CLEANING THE PET TOOL DUE TO THE NUMBER OF SMALL PARTS. CLEAN THE PET TOOL BRUSH BAR ON A REGULAR BASIS.

WARNING - MUST READ

DO NOT USE ANY CHARGING ADAPTORS WITH THE VACUUM CLEANER OTHER THAN THE ONE SUPPLIED.

DO NOT USE THE VACUUM CLEANER WITHOUT THE HEPA FILTER OR FILTER CONE IN POSITION; THE HEPA FILTER AND FILTER CONE MUST BE CORRECTLY FITTED BEFORE USE.

FAILURE TO ADHERE TO THE ABOVE COULD CAUSE DAMAGE TO THE VACUUM CLEANER.

FOLLOW THE INSTRUCTIONS BELOW TO CLEAN AND REFIT THE HEPA FILTER:

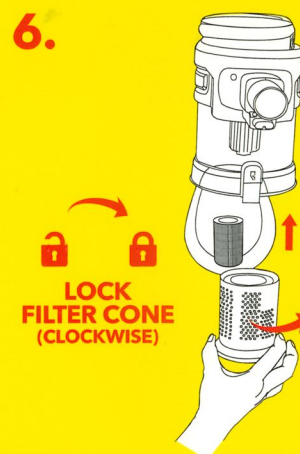
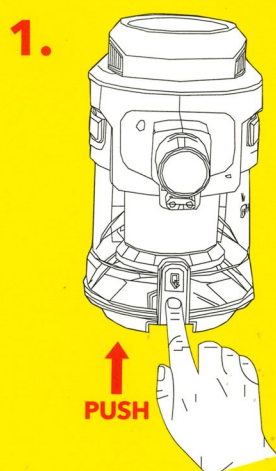

**IMPORTANT: THE ADAPTOR SUPPLIED
SHOULD ONLY BE USED WITH THIS
PRODUCT.**